

Horizontal Panel

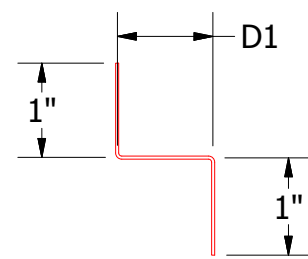

Support Z
DWA681: D3= 1"
DSA681: D3= 1 5/8"

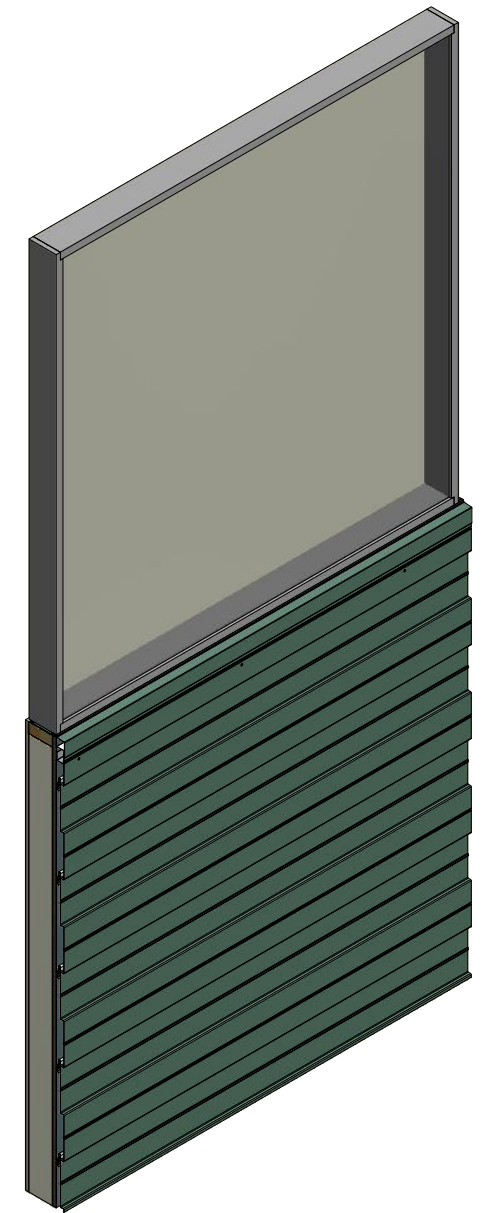
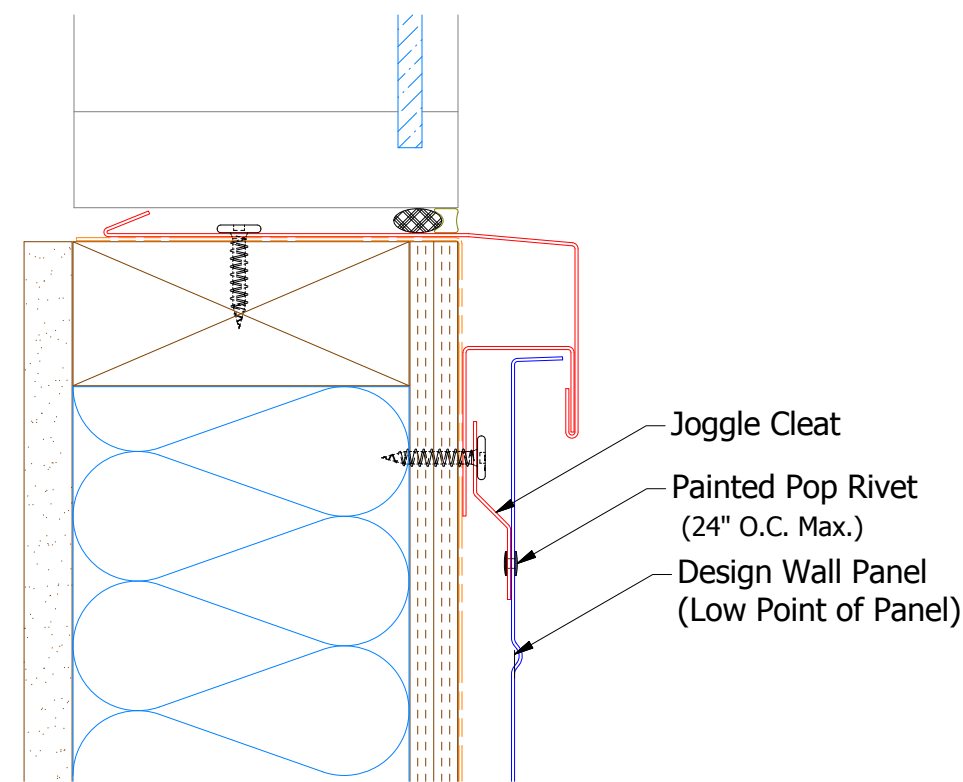
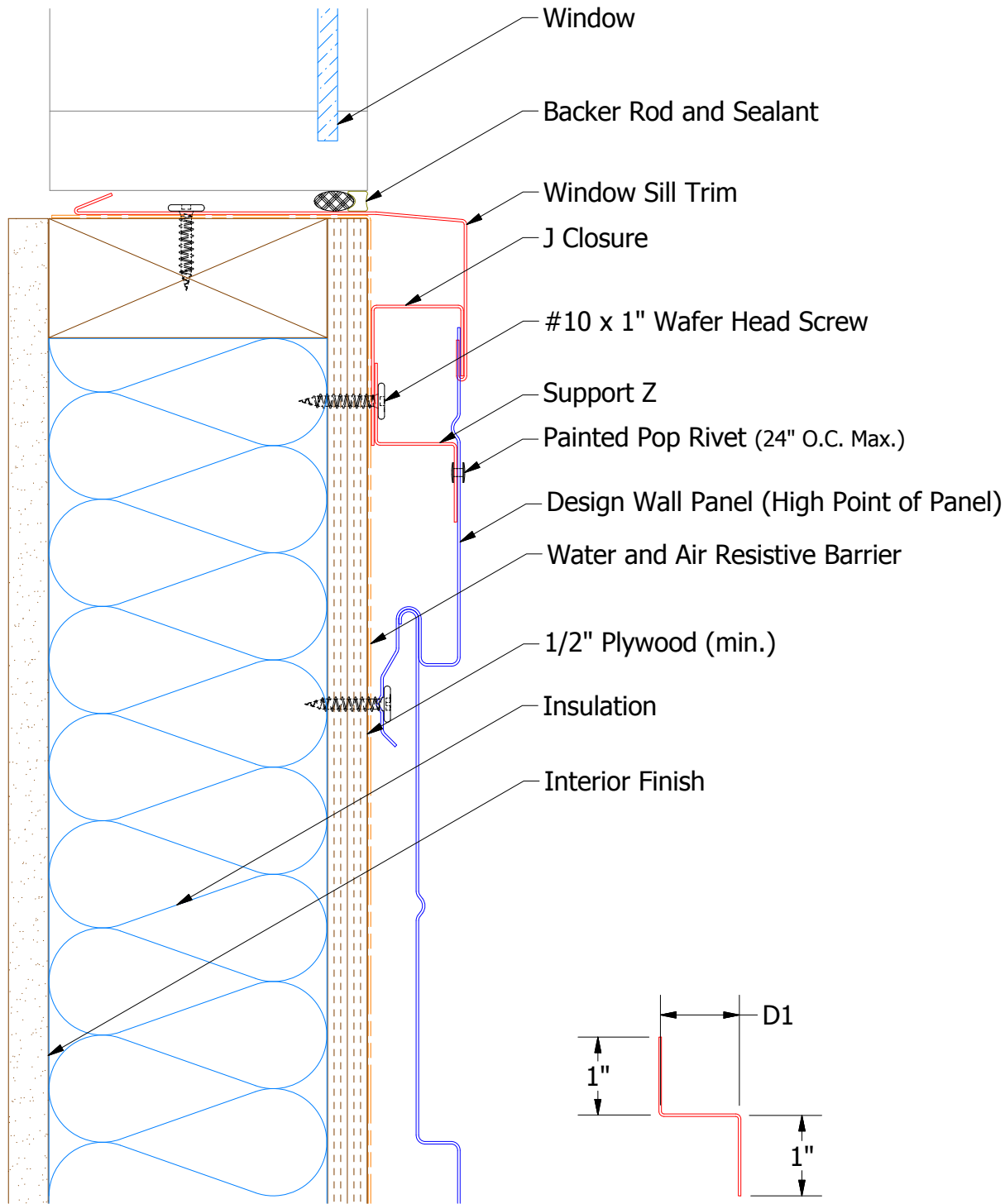
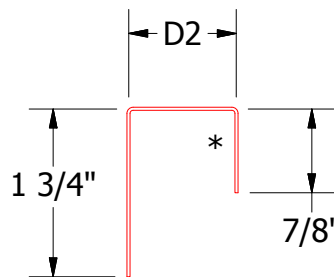

J Closure
DWA270: D2= 1 1/8"
DSA270: D2= 1 7/8"

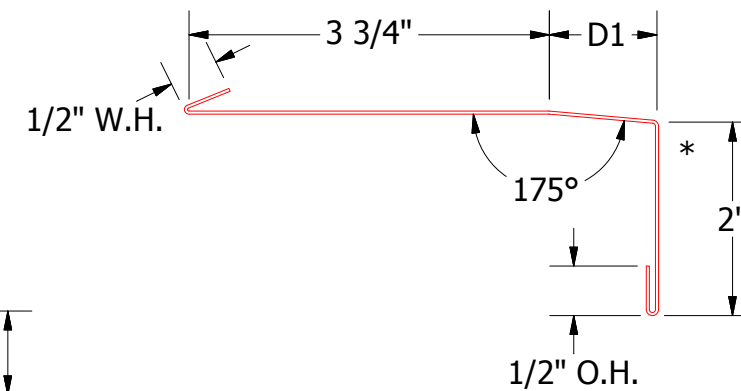

Window Sill Trim
DWA670: D1= 1 1/8"
DSA670: D1= 1 13/16"

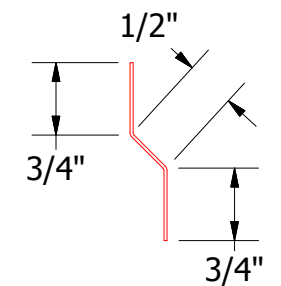

DWA975/DSA975 - Joggle Cleat

REV. NO.	DATE	DESCRIPTION OF REVISION	BY	APP

ATAS ATAS INTERNATIONAL, INC
Allentown PA
610-395-8445
Mesa AZ
480-558-7210

TITLE **Design Wall Window Sill Detail**

DWG. NO.	DR	DATE
	DMR	6/29/2016
MATERIAL	APP	DATE
	DAS	7/26/16
	SH. SIZE	SCALE
	B	X:X